

Cardiff Central Station



New City Centre Station

Complete replacement of the northern side of Cardiff Central Station including track realignment and consequential alternations to platforms. Oxford Architects were engaged by the design and build contractor BAM Construction to provide all architectural design services from and including Network Rail Form B submission to completion.

The station remained in use during construction necessitating a complex phasing of the works. The subway slab was cast on Christmas day. The new building provides a ticket office and associated staff accommodation, a gate line, lifts and stairs up to first floor platform access and generous circulation spaces designed to accommodate peak flows generated by the Millennium Stadium.

Project Details

- **Scope**
Replacement of 650sqm city centre station
- **Role**
Architectural design
- **Client**
BAM/Network Rail
- **Contractor**
BAM
- **Contract**
Design & Build
- **Value**
£6m
- **Dates**
Completed 2015



Key Aspects

- Interface with Grade II Listed building
- Blastproof construction
- BREEAM Very Good energy rating
- Co-ordination with new tracks and platforms
- Network Rail consents process
- Stakeholder consultation

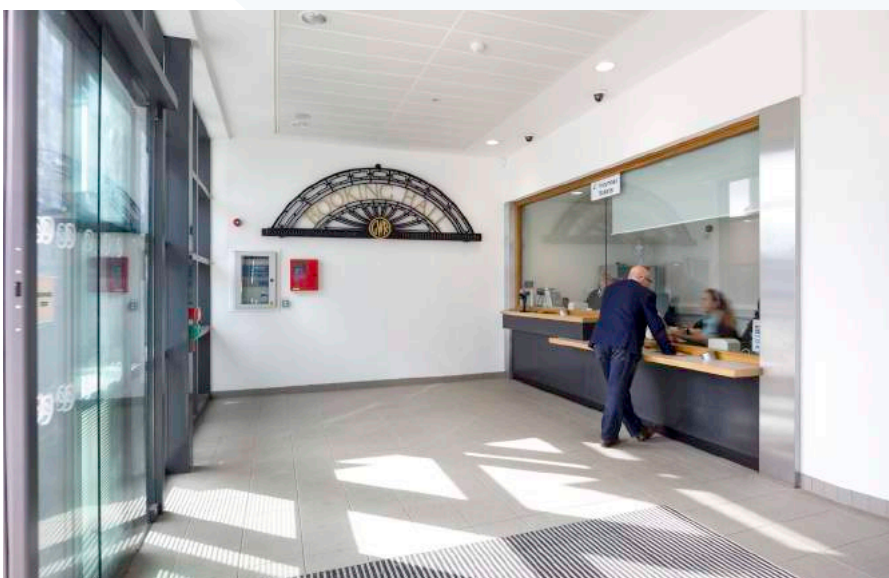

www.oxford-architects.com