



OXFORD
Bagley Croft
Hinksey Hill
Oxford
OX1 5BS
Tel: 01865 329 100

BRISTOL
The Workshop
254 Southmead Road
Bristol
BS10 5EN
Tel: 0117 958 1500

BRISTOL
The Workshop
254 Southmead Road
Bristol
BS10 5EN
Tel: 0117 958 1500

www.oxford-architects.com





Introduction

Oxford Architects has a long-standing and distinguished reputation for delivering high-quality community buildings across the UK. As a nationally recognised architectural practice, we bring a thorough understanding of the unique challenges and opportunities associated with designing and constructing within the community sector.

Our practice offers a comprehensive range of architectural services, from initial brief development and masterplanning through to design progression, visualisation, and the preparation of detailed production information to support competitive procurement processes.

Our portfolio spans a broad spectrum of sectors, including Education, Research, Healthcare, Transport, Commercial, Community, Industrial, and Residential. This diverse experience enables us to draw upon cross-sector expertise, ensuring innovative, practical, and contextually appropriate solutions for every commission.



Pictures: Florence Park

Methodology

Our methodology is rooted in collaboration, careful listening, and a deep understanding of our clients' aspirations. We believe that successful outcomes emerge from strong working relationships, and we prioritise early engagement to fully understand the context, ambitions, and constraints of each brief.

We draw on a broad portfolio of experience across multiple sectors, enabling us to apply lessons learned from diverse project types to community-focused developments. This cross-sector approach often brings added value, introducing innovative solutions that may not have otherwise been considered.

Recognising that each community project is unique, we tailor our approach to respond to the specific needs of the client and the wider user group. Through a process of structured dialogue and ongoing consultation, we develop design responses that are both creative and practical - ensuring they are flexible, robust, and aligned with long-term objectives.

Our process supports projects from initial concept through to delivery, ensuring continuity of vision and quality at every stage.

Pictured: Fairfield Residential Home



Pictures: Fairfield Residential Home



Design Approach

The design of community buildings must prioritise flexibility and inclusivity, taking inspiration from the people and communities they are intended to serve. These buildings are required to support a broad range of activities, often simultaneously, and must accommodate different user groups, numbers, and times of use.

At Oxford Architects, we draw on our experience and creative expertise to develop adaptable and responsive design solutions that not only fulfil the project brief but also exceed client expectations. Our approach is grounded in the belief that thoughtful, user-centred design is fundamental to the long-term success of community spaces.

Community engagement is a key component of our design process. We believe meaningful consultation is essential in shaping spaces that are truly reflective of the needs and aspirations of their users. We have extensive experience in organising, facilitating, and leading public consultation events and stakeholder workshops - creating productive forums for dialogue, feedback, and shared ownership of the design vision.



Wildwood Church, Staffordshire



Kingston Bagpuize Pavilion, Oxfordshire

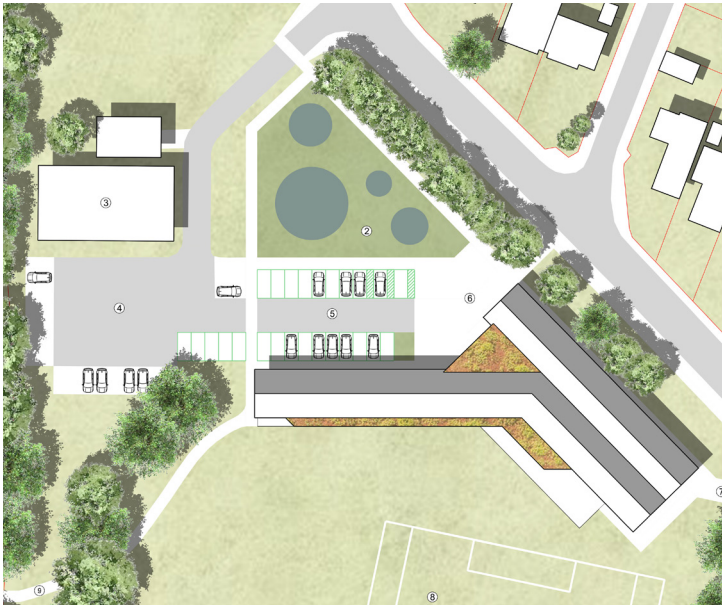

Thame Youth Hub, Oxfordshire

Our Experience

Oxford Architects has delivered a wide range of successful community projects across the UK, each tailored to the needs of its users and setting:

- Lyde Green Community Centre, Bristol**
 New Multi-Use Hall, Changing Rooms, Meeting Rooms, Catering Kitchen and central ‘Circulation Street’ (£1.5 million)
- ParkLife Wildwood Church, Stafford**
 New Community Building including Multi-Use Hall, Café, Soft Play, Community Function Rooms and Offices (£2.5 million)
- Tidworth Civic Centre and Wiltshire Police CPT Building**
 New multi-use community hub with Police CPT Building and co-working spaces for start up businesses (£5.1 million)
- Bromham Community Hub, Bromham**
 New 500m² community hub building with a multi-functional hall, café/lounge, kitchen and bar facilities, set within a wider outline site masterplan to include a shop, new sports pavilion, and 3 houses. (£1.4 million)
- New PYE Gallery at Banbury Museum, Banbury**
 Project to extend the Museum providing new exhibition galleries and flexible spaces for lectures, films and private hire (£750,000)
- Soldiers of Oxfordshire Museum, Oxford**
 A new museum to provide contemporary audiences an insight into how conflict has affected the people of Oxfordshire and an educational facility for the future (£2.35 million)



Bromham Community Hub, Wiltshire



Lyde Green Community Centre, Bristol



Tidworth Civic Centre and Wiltshire Police CPT Building, Wiltshire